

Quick-Connect Poster

YHT-685

Home Theater in a Box

home theater

YAMAHA

Yamaha created this package to greatly enhance your audio and home theater enjoyment. This Quick-Connect Poster will help you get started. Follow the steps to connect the speakers first. Then connect your DVD Player and other components. Refer to your Owner's Manuals as well as those that came with your other components for complete instructions and precautions. *Be sure that all components are not plugged in while making connections.* You will need the following which are not included in the package: Phillips screwdriver, wire cutter/stripper, optional for wall mounting: brackets, toggle bolts, molly anchor screws or sheet metal screws.

1 Your System



Inspect Contents After unpacking, inspect the contents to confirm you have the above items: 1 two front speakers, 2 two surround speakers, 3 one center speaker, 4 subwoofer, 5 HTR-6030 A/V Receiver with remote control, 6 DV-S5860SL DVD Player with remote control, 7 speaker wire, 8 subwoofer RCA cable, 9 audio/video RCA cable, 10 non-skid pads, 11 screws, 12 support bases and adapters (attached to speaker stands) 13 fasteners. Also included, but not shown, are AM and FM antennas and related Owner's Manuals.

2 Room Layout

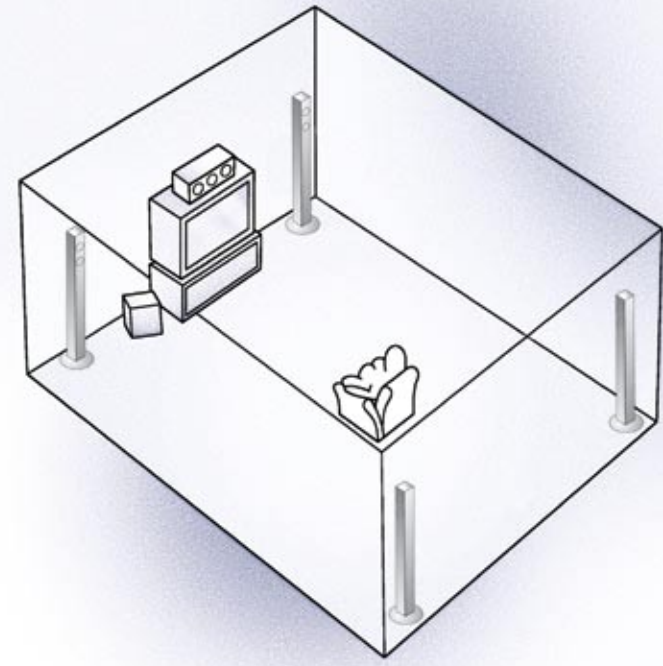

Speaker Placement After connection of the speakers place them so they appear in the approximate positions as shown in the diagram above.

3

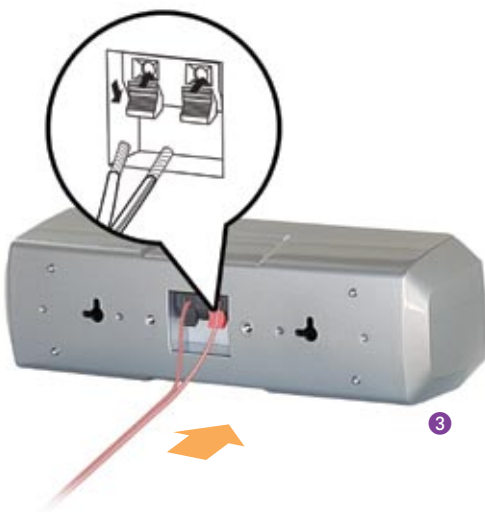

Connect Center Speaker Wire

Cut speaker wire 7 to appropriate lengths for all speaker connections. Connect speaker wire for center speaker 3. The positive (+) side of the wire with the white stripe attaches to the red terminal. The negative (-) side attaches to the black terminal. (See your HTR-6030 Owner's Manual for more information on speaker wire connections.)
Note: Fasteners 13 are included for secure speaker mounting. See your NS-AP8600/SPS-8600 Owner's Manual for further instructions.

4



Front and Surround Speaker Assembly

Attach Bottom Pads Apply pads 10 to bottom of speaker stand as shown.

5



Thread Speaker Wire Pass the speaker wire through the underside of speaker stand.

6



Turn Speaker Stand Right-Side-Up Remove screw that holds adapter in, carefully set aside, then remove adapter from speaker stand.
Thread Speaker Wire Make sure speaker wire continues to pass through the adapter.

7



Connect Front and Surround Speaker Wire Positive (+) side of the wire with white stripe attaches to (+) terminal. Negative (-) side attaches to (-) terminal.

8



Attach Adapter to the Speaker using the supplied screw 11.

9

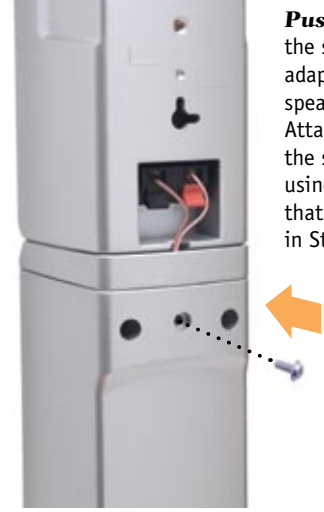

Push Together the speaker and adapter into the speaker stand. Attach adapter to the speaker stand using the screw that was set aside in Step 6.

10

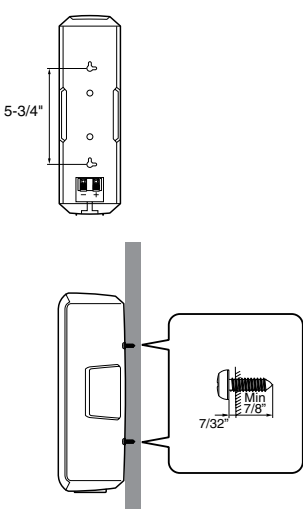

Mounting Speakers to Wall (Optional) Fasten mounting screws into a firm wall or wall support. Leave 7/32 in. between head and wall. Hang the keyholes on the speaker backs on the protruding screws.
WARNING Please contact a reliable source about the best type of hardware for your particular wall's construction. Secure installation is purchaser's responsibility. See your owner's manual for additional precautions.

11

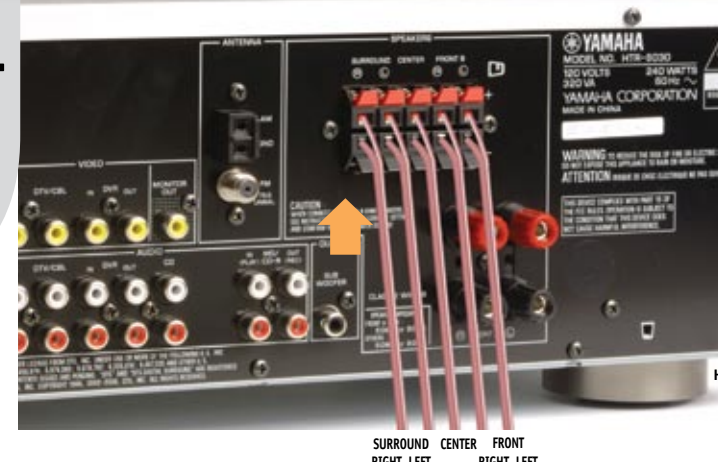

Receiver Connections

Connect Speakers Positive (+) side of the wire with white stripe attaches to (+) terminal. Negative (-) side attaches to (-) terminal.
CAUTION Receiver must not be plugged in while connecting speakers.

12



Subwoofer Connection

Connect RCA Cable Connect RCA cable 9 to subwoofer 4. Set subwoofer VOLUME control to half-way mark and POWER to OFF. Connect RCA cable to receiver from subwoofer.
WARNING Components must not be plugged in while connecting them.

13

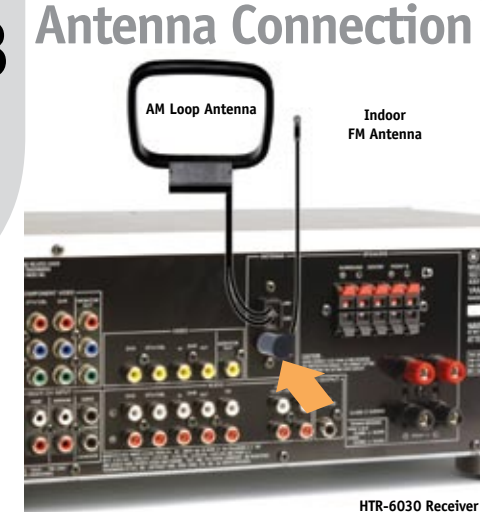

Antenna Connection

Connect Antennas to Receiver Locate AM loop antenna and indoor FM antenna. Keeping receiver unplugged, connect as shown. For more information about obtaining clear reception and grounding, see your Owner's Manual.

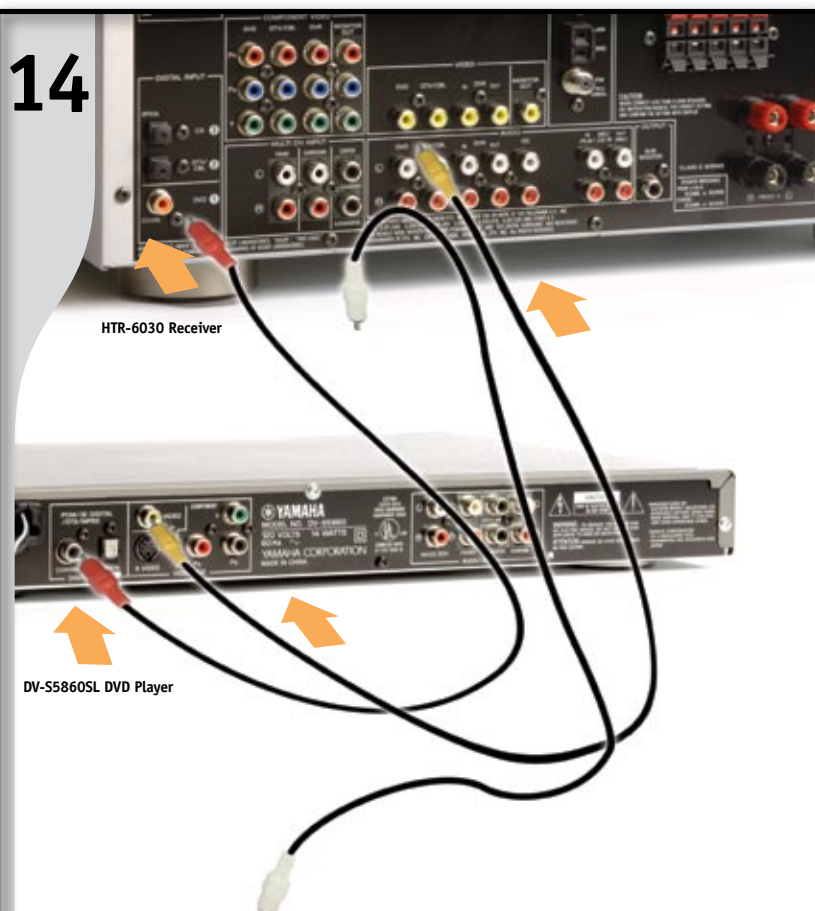

14

DVD Player Connection

Connect DVD Player Top: Connect RCA audio/video cables (9) to receiver: Yellow to "DVD," Red to "Digital Input DVD Coaxial" as shown, and leave White unplugged. Bottom: Connect audio/video cables to DVD player from receiver: Yellow to "Video", Red to "Coaxial", and leave White unplugged.

WARNING Components must not be plugged in while connecting them. Wait until all connections are made before plugging in your components.

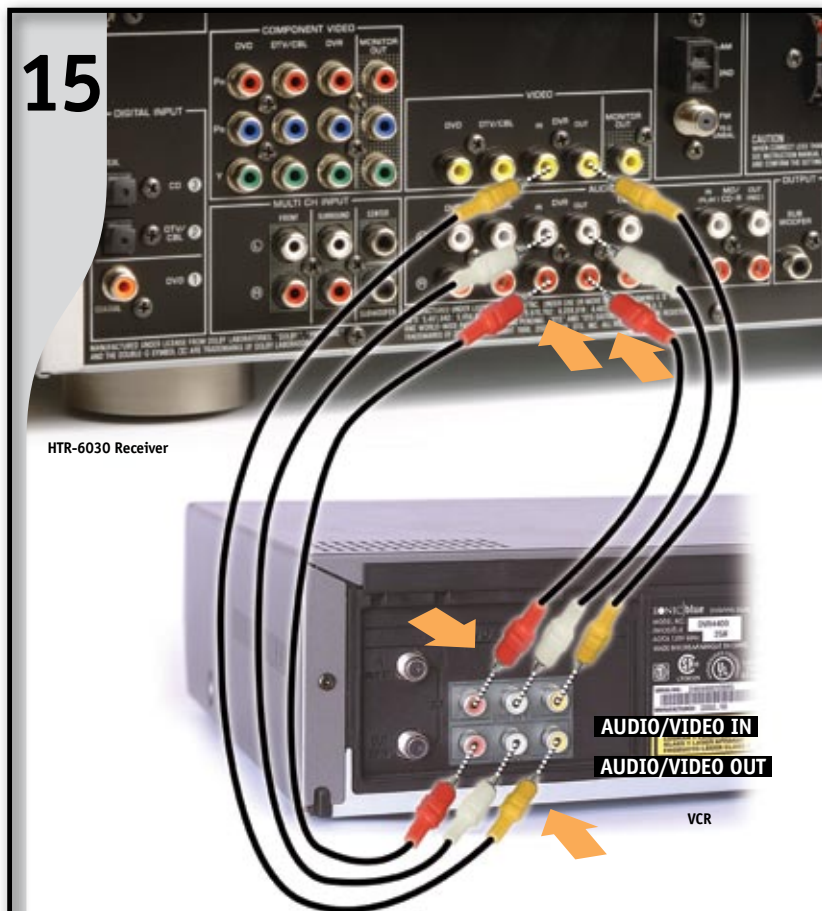

15

VCR Connection

Connect VCR (optional) Connect audio/video cables (not included) as shown.

NOTE VCR shown is for illustration purposes only. When using a hi-fi stereo VCR, set the Tuner/Line switch on the VCR to "Line" position to record from another source connected to the HTR-6030 receiver.

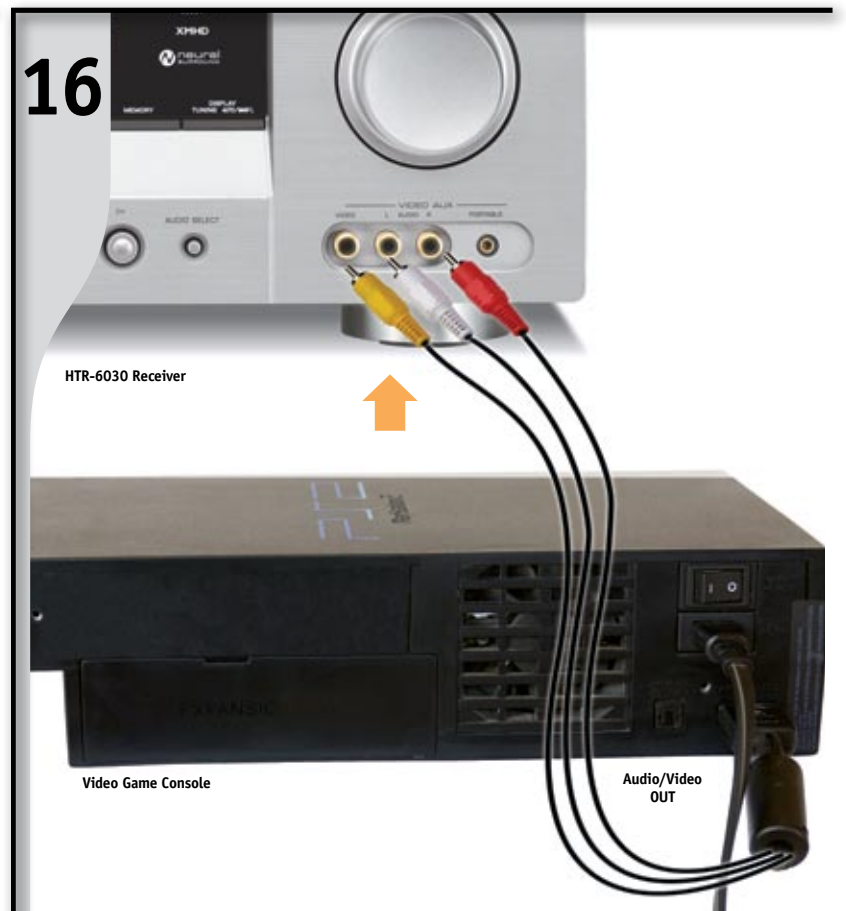

16

Video Game Console Connection

Connect Game Console or Video Camera (optional) Connect RCA audio/video cables (not included) as shown.



17

MP3 Player Connection

Connect MP3 Player (optional) Connect a 3.5 mm stereo mini cable (not included) from line out or headphone jack of the MP3 player to the PORTABLE input on the receiver as shown.

WARNING MP3 player volume must be turned down to half before connecting. Consult the MP3 player's Owner's Manual for further instructions.

NOTE The PORTABLE mini jack input takes priority over the AUDIO L/R jacks.



18

DSS/Cable/HDTV Tuner Connection

Connect DSS/Cable/HDTV Tuner Box (optional) Connect RCA audio/video cables (not included) and optional optical cable (not pictured) to "DTV/CBL" terminals on receiver to A/V OUT connections on Box as shown.



19

Video Monitor Connection

Connect a Video Monitor (optional) Connect an RCA video cable (not included) to receiver Monitor OUT from your video monitor as shown.



20

CD Player Connection

Connect CD Player (optional) Connect RCA audio cables (not included) to "CD" terminals on receiver as shown. If your CD Player has digital output terminal, connect digital cable (not included) to HTR-6030 Receiver Digital Input terminal. See your HTR-6030 Owner's Manual for more information.



21

MD/CD-R Player Connection

Connect MD/CD-R Recorder (optional) Connect RCA audio cables (not included) to "MD/CD-R" terminals on receiver as shown.



22

Plug In receiver and other components. Power on the receiver first, and the other components next. Adjust volume on the receiver. Please see each of your respective Owner's Manuals for recommended guidelines and settings.



Enjoy the Yamaha Home Theater Experience
 Be sure to put batteries in your remotes (see Owner's Manuals for instructions). Refer to your Owner's Manuals for each component in your system for more information. Now, relax and enjoy the unparalleled sound of your Yamaha Home Theater system.

YAMAHA ELECTRONICS CORPORATION, USA
 6660 Orangethorpe Avenue
 Buena Park, CA 90620
<http://www.yamaha.com>
 Phone: 1-800-292-2982